

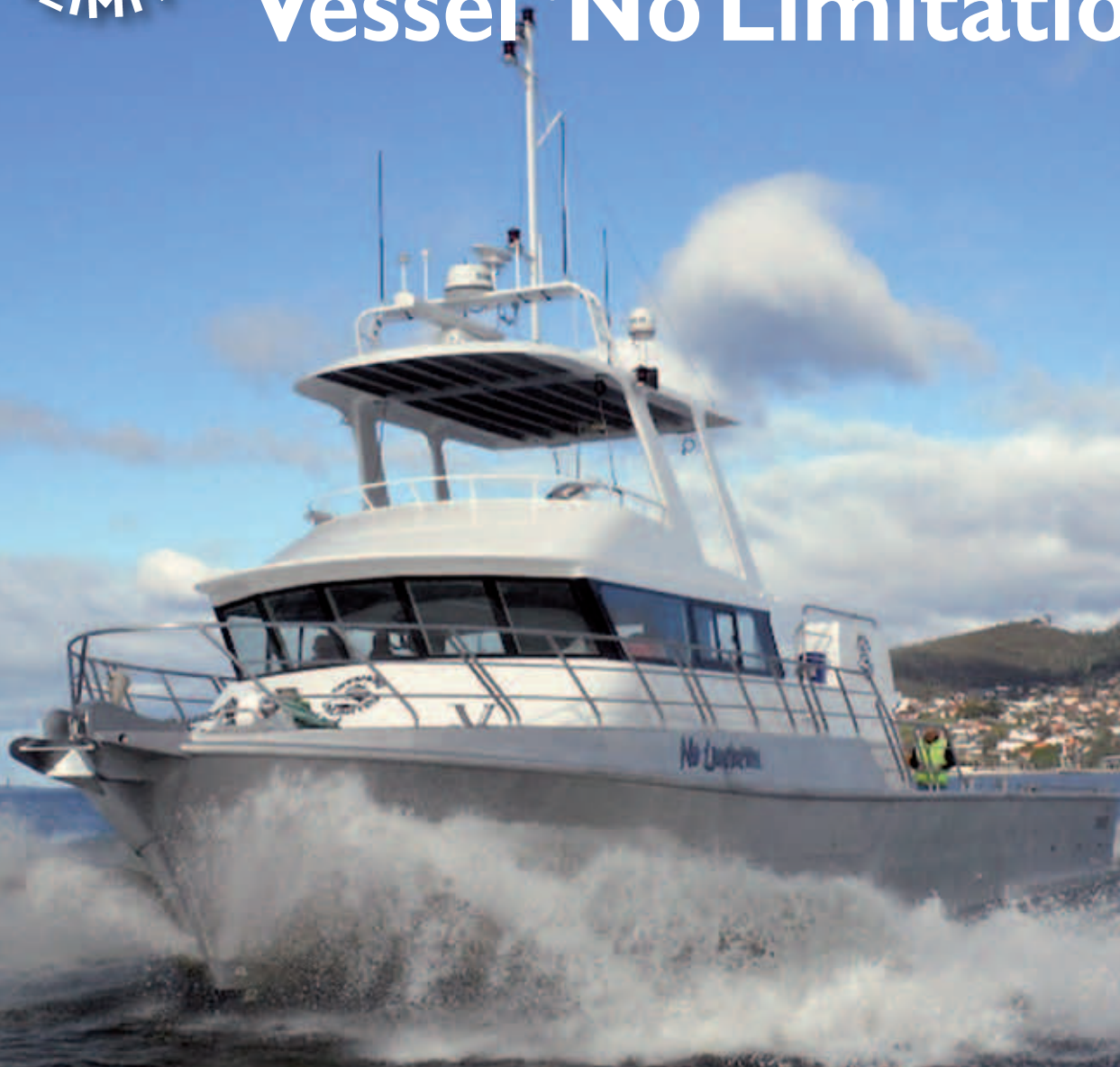

Multi-Purpose Offshore Support Vessel 'No Limitation'



www.offshoreunlimited.com.au





NO LIMITATION - SPECIFICATIONS

Built 2001 by Legend Boat Builders, Western Australia, Australia

CLASSIFICATION

Marine & safety: AMNSA USL 2B, 1C.
M number: 0202
Call sign:

MACHINERY

Main engines 2 x Caterpillar C18 700Kw
Gear box 2 x Twin Disc Quick Shift

Propeller 2 x Mikado 5 blade
Auxiliary engines 1 x 50 k V a
1 x 14 kva

SPEED AND CONSUMPTION

Maximum Speed 25 knots
(2164 rpm)

Economical Service Speed 21 knots
(1800 rpm)

CAPACITIES

Cargo 12 tonne
Clear Deck 10 m x 5.4 m
Power 2 x 3 phase reefer plugs 32amps
Fuel 14,900 litres
Water 800 litres
(Plus desalinator 5800 litres per day)

DECK EQUIPMENT

Hiab crane 1060 kg @ 5.35m
805 Kg @ 6.95m
Winch capstain 1.5 tonne

HULL

Aluminium mono hull
Fendering on bow, stern and sides
5.4 M open transom

DIMENSIONS

Length LOA 23m
Beam 5.4m
Draft 1.8m

BRIDGE

Fully enclosed helm position

Flybridge Engine controls & 2nd steering
Radar Raymarine 48nm, Furuno 48nm
Plotter Maxsea, Simrad
Gps Furuno GP31,

AIS

Sat communications Sailor Fleet Broadband, Irdium
Pilot, Telstra 4G Voice Fax Date
Furuno

Auto pilot

HF radio Icom with Auto Tuner

VHF radio Icom x 2

VHF handhelds Icom ICM 33 x 3

Searchlight Aircraft landing light 240v

Compass kvh gyrotrac, Plastimo

Fire monitoring magnetic Chubb Fm200

Inverter

EPIRB McMurdo 406

ACCOMMODATION

Total 12 berth, fully airconditioned. 8 Persons plus 2 crew overnight. 32 Persons plus 2 crew day trip (Can be increased with temporary permit). TV, Video, dvd player, Foxtel TV and cd in main saloon fully equipped galley, large freezer and refrigerator space. 2 X toilets and showers. Fixed A-Frame available.



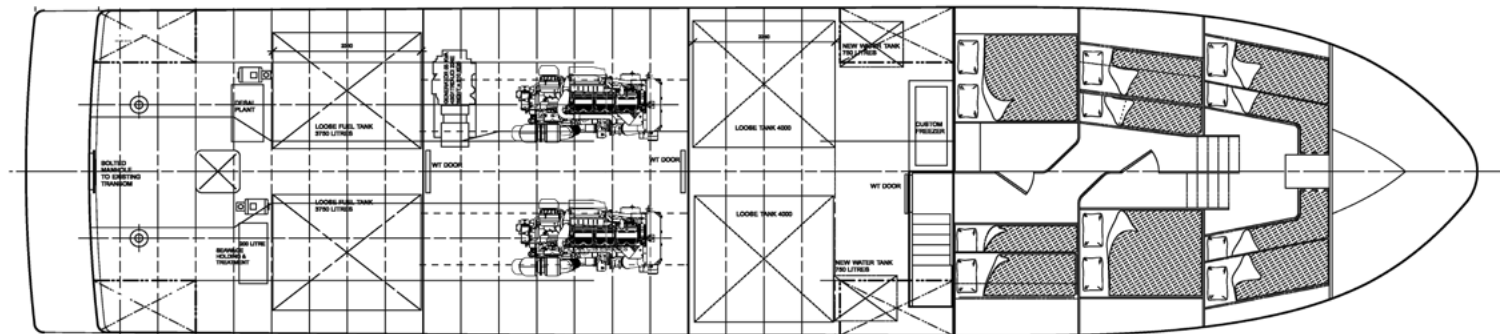
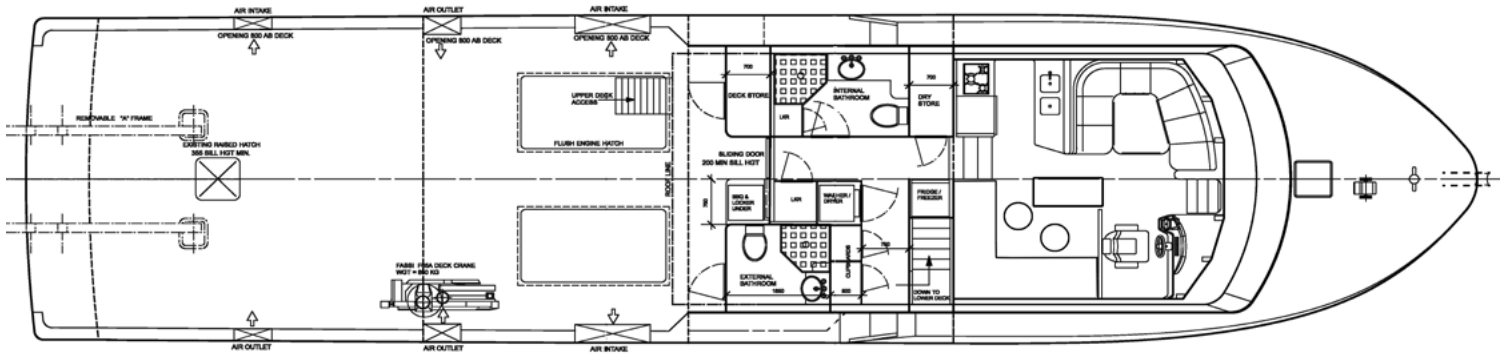
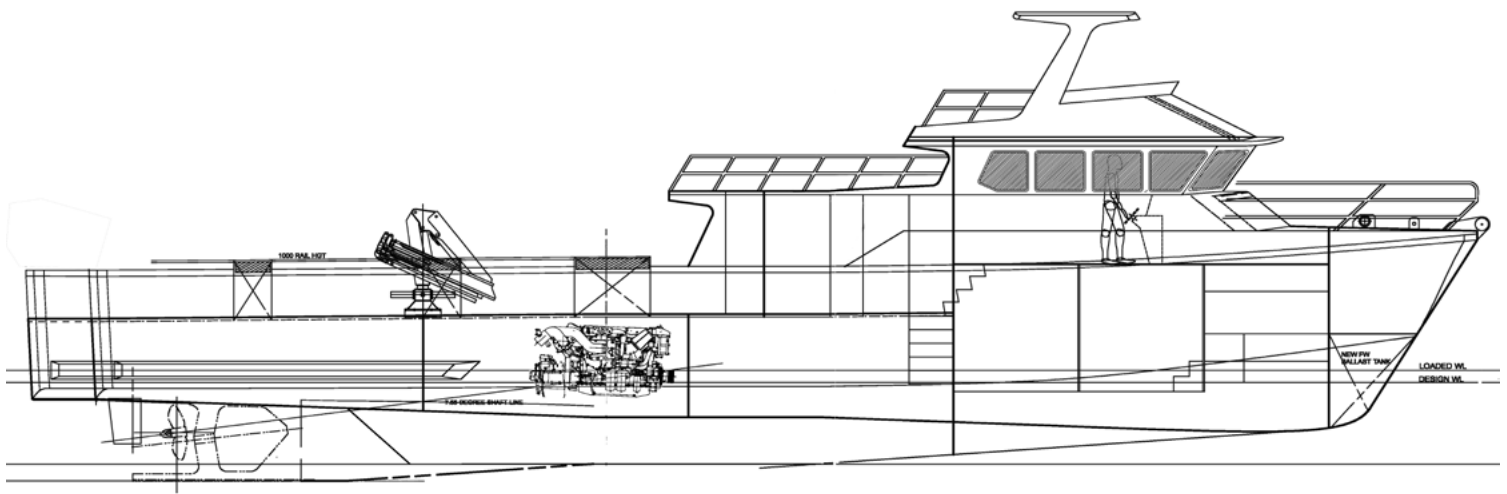

OFFSHORE UNLIMITED PTY LTD
info@offshoreunlimited.com.au
Tel 03 6235 7157 Fax 03 6235 7199
www.offshoreunlimited.com.au



OFFSHORE UNLIMITED PTY LTD
info@offshoreunlimited.com.au
Tel 03 6235 7157 Fax 03 6235 7199
www.offshoreunlimited.com.au

